

FILTERING

WOUND BEADS

Applications

- The R6H type wide-band chokes are mainly used in PC boards to filter the EMI from outside sources.

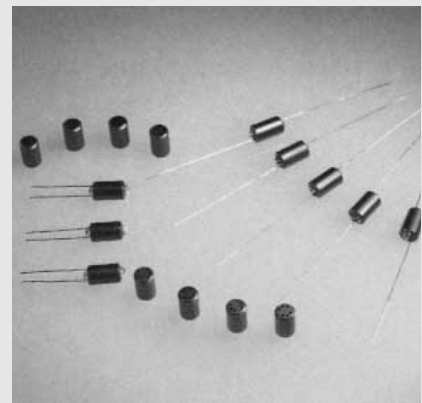
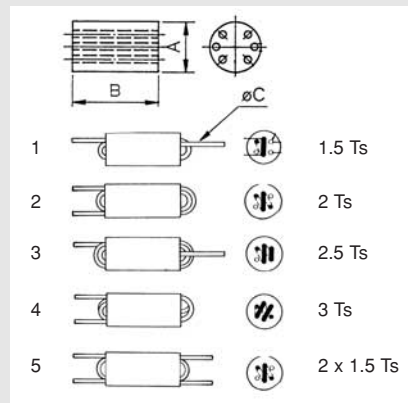

Part No.	Unit: mm			Impedance (Ω)		Fig.
	A	B	ϕ C	25MHz	100MHz	
R6H-Type						
R6H 6-10-0.85-1.5TS	6.0 \pm 0.25	10.0 \pm 0.4	0.5	390	460	1
R6H 6-10-0.85-2TS	6.0 \pm 0.25	10.0 \pm 0.4	0.5	510	580	2
R6H 6-10-0.85-2.5TS	6.0 \pm 0.25	10.0 \pm 0.4	0.5	690	680	3
R6H 6-10-0.85-3TS	6.0 \pm 0.25	10.0 \pm 0.4	0.5	860	750	4
R6H 6-10-0.85-2x1.5TS	6.0 \pm 0.25	10.0 \pm 0.4	0.5	340	450	5

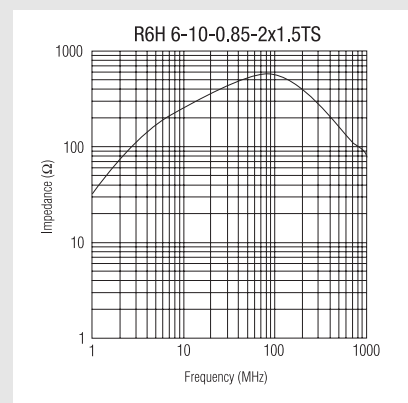
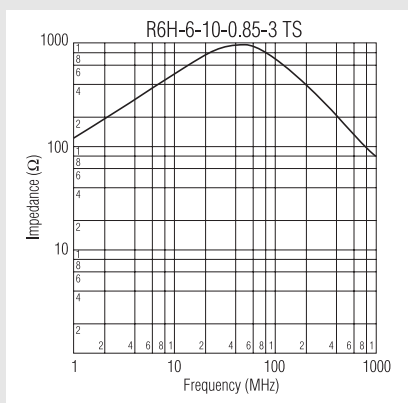
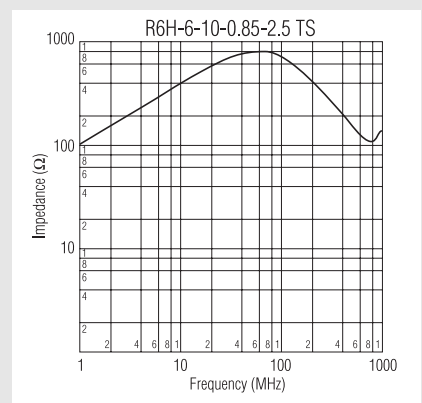
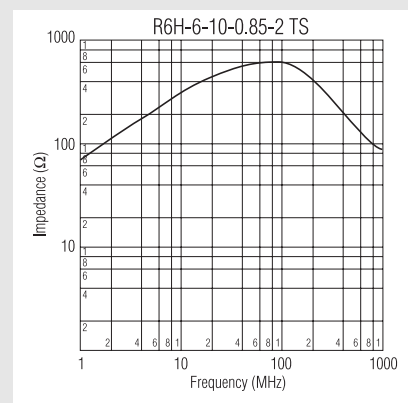
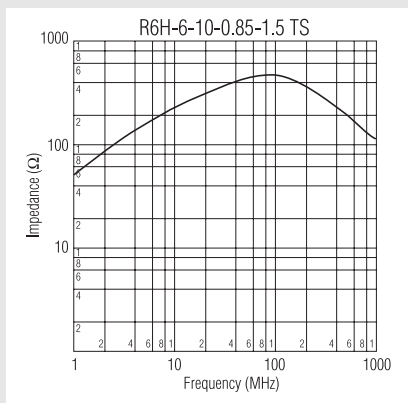

FILTERING

WOUND BEADS

Features

- Ferrite beads are used to remove high frequency noise.
- Are supplied taped, suitable for automatic insertion into p.c. boards.
- Rated current 6A

Applications

- Noise suppression of on-board components of personal computer, word processor, facsimile and other digital equipment.

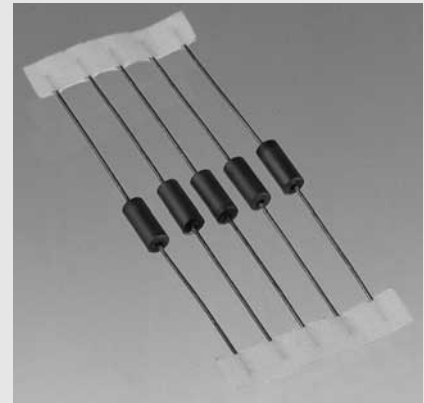
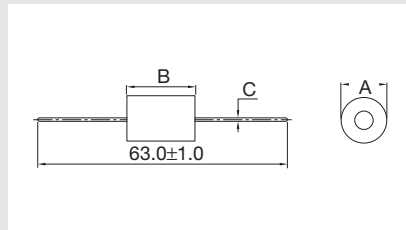

Rated current	6A
Working temperature	-25°~+85°C

Part No.	Unit: mm			Impedance (Ω)	
	A	B	∅C	25MHz	100MHz
RH 3.5-4.7-0.8	3.5	4.7	0.65	52	82
RH 3.5-6.0-0.8	3.5	6.0	0.65	57	84
RH 3.5-7.5-0.8	3.5	7.5	0.65	91	111
RH 3.5-8.0-0.8	3.5	8.0	0.65	88	138
RH 3.5-9.0-0.8	3.5	9.0	0.65	97	117
RH 3.5-14.0-0.8	3.5	14.0	0.65	141	210

